

## PETIT

851-s1810w24

PETIT SURFACE MOUNTED WALL LUMINAIRE made of aluminium, anthrazite, transparent glass light output direct, with converter, dimmability: not dimmable, IP65

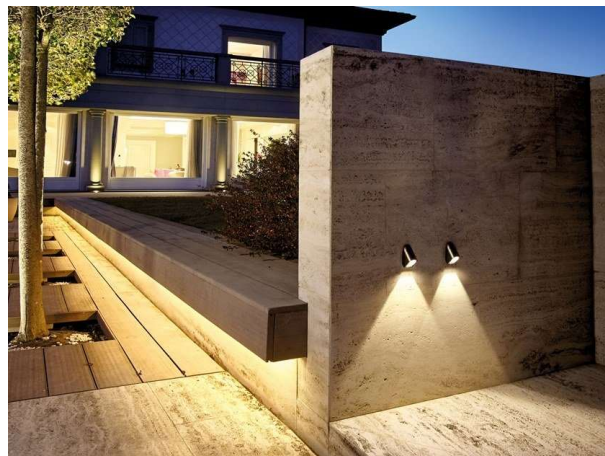

## DRAWING

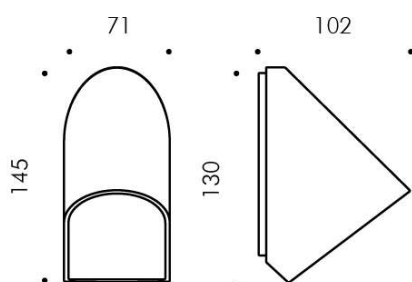

## LIGHT DISTRIBUTION CURVE

## TECHNICAL DETAILS

System perform. [W]	15
Bulb type	LED
Luminous flux [lm]	528
Colour temp. [K]	3000K
CRI	>90
Optics	transparent glass
Converter	with converter
Dimming	not dimmable
Light output	direct
Voltage [V]	220-240V AC/DC
Material	aluminium
Length [mm]	145
Width [mm]	71
Height [mm]	102
IP protection class	IP65
Voltage class	protection cl. I
Shock resistance	IK07
Net weight [kg]	1,30
Colour lamp	anthrazite
EAN-Number	8051163013033
Lifetime [h]	50 000 L70 B20
Energy efficiency cl.	F



The values are rated values. Power and luminous flux are initially subject to a tolerance of +/- 10%. Colour temperature tolerance: +/- 150 K. The values apply to an ambient temperature of 25°C unless otherwise specified.